

# Nokia Intrusion Prevention with Sourcefire



# Nokia for Business

## 3D Network Defense for Nokia

The abundance of mobile devices, wireless networks, remote access solutions and outsourcing is causing the network perimeter to rapidly dissolve. Each of these entry points into the network represents an additional opportunity for compromise, threats and malicious activity. As threats evolve and the perimeter lines blur, the need for a defense-in-depth strategy becomes paramount to securing today's critical network infrastructure.

Designed for medium to large enterprises, branch offices or remote sites, Nokia IP390 is a security appliance optimized for Sourcefire Intrusion Sensor™ and Real-time Network Awareness™ (RNA) Sensor applications. Combining the market leading design and performance of a hardened Nokia appliance and Operating System with leading Intrusion Prevention technology, Nokia and Sourcefire provide advanced, multi-layered network security. Built on the Sourcefire 3D System—Discover, Determine, and Defend—Nokia Intrusion Prevention helps organizations proactively defend and protect their networks, entry points, applications and data.

## Sourcefire Intrusion Sensor for Nokia IP390

Sourcefire Intrusion Sensors offer an advanced intrusion detection and prevention solution

that provides defense-in-depth by analyzing network traffic and either blocking, replacing or alerting when suspicious activity is detected. Utilizing the award-winning Snort® rules-based detection engine, Sourcefire Intrusion Sensors achieve the industry's highest rate of attack detection and prevention.

Sourcefire Intrusion Sensors for Nokia IP390 offer extensive flexibility to support the threat prevention needs of enterprise networks regardless of size, topology or composition and are available in two versions: running at 250 Mbps of inspected traffic and running at 400 Mbps of inspected traffic.

## Sourcefire RNA Sensor for Nokia IP390

Sourcefire RNA Sensors provide a layer of intelligence to network monitoring through a combination of passive network discovery, behavioral profiling and integrated vulnerability analysis to deliver the benefits of real-time network profiling and change management. RNA's innovative technology constantly monitors all network assets and provides a persistent view of: network asset and behavioral profiles (MAC address, OS and version, traffic flow and traffic type), network profiles (hop count, TTL parameters, MTU parameters, etc.), security vulnerabilities, and change events (new assets, changed assets, behaviorally anomalous assets, etc.)



This information, coupled with the RNA vulnerability database, allows you to know possible vulnerabilities on your network and take the appropriate action to automatically remedy them.

## Sourcefire Defense Center for Nokia

The heart of the 3D System, Sourcefire Defense Center™ unifies and centrally manages critical network security functions, including event monitoring, correlation and prioritization for incident response, forensic analysis, trend analysis, and management reporting. By tightly integrating the threat intelligence of Sourcefire Intrusion Sensors for Nokia IP390 with the endpoint network intelligence of Sourcefire RNA for Nokia IP390, Sourcefire Defense Center correlates and analyzes events in real-time to determine relevance, impact and criticality of threats to any network.

Sourcefire Defense Center for Nokia provides protection by analyzing events in real-time and enabling automated responses according the ABCs of defense: alert, block, correct.

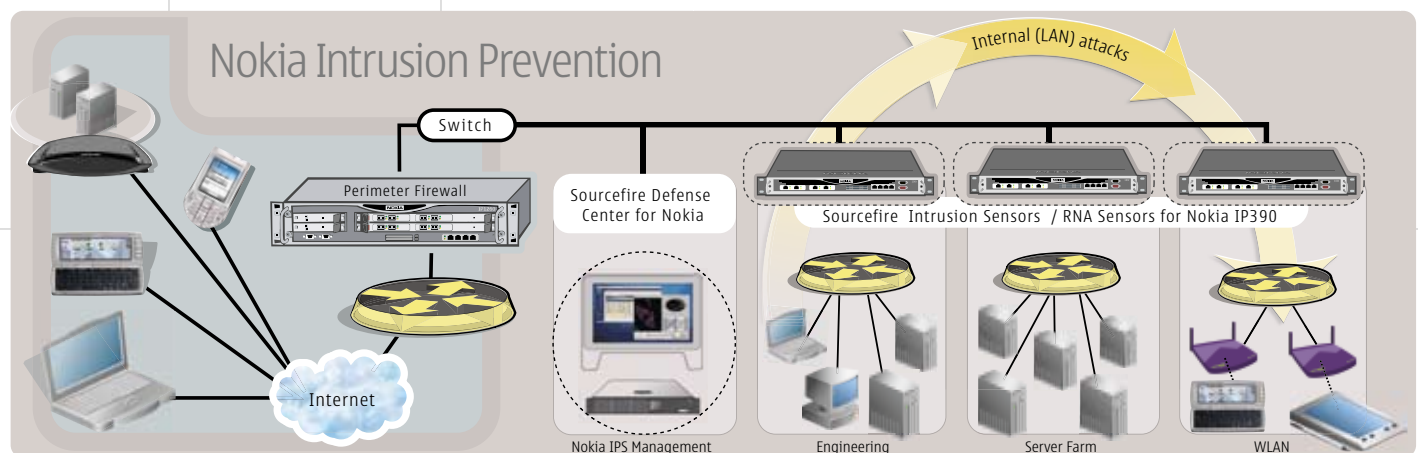

## Consistent Inline Reliability

Nokia Intrusion Prevention appliances are purpose-built to protect corporate applications and data while running inline within the world's most demanding network environments and are architected specifically for the demands of the Sourcefire technology. Nokia IPSO™ LX is a security hardened, operating system which has added features designed to make integration into complex networks transparent.

## Ease of Management

To increase administrator productivity, Nokia Intrusion Prevention appliances make

executing sophisticated security simple. Nokia Network Voyager provides a simple and comprehensive method of configuring and managing an appliance or gateway, thus removing much of the complexity of managing an appliance. All configuration data is stored in a central configuration database for ease of maintenance.

## Simple Acquisition and Implementation

Nokia Intrusion Prevention appliances minimize acquisition and installation complexity. Stable hardware configurations are pre-tested and pre-integrated with Nokia IPSO and Sourcefire Intrusion Sensor and RNA

Sensor software. Sourcefire Intrusion Sensor and RNA Sensor software is preinstalled on the appliance, and native Nokia IPSO features are included without any additional installation, licensing, or activation required.

## Nokia First Call—Final Resolution Support

Best of all, like all Nokia IP Security appliances, the complete Nokia Intrusion Prevention product line is backed by world-class Nokia First Call—Final Resolution support and service. Nokia First Call—Final Resolution offers a single point of technical support and assistance for both Nokia Intrusion Prevention appliances and Sourcefire software.

## Technical Specifications

<b>LAN Support</b> <ul style="list-style-type: none"> <li>10/100 BASE-TX (10/100 Mbps Ethernet), copper</li> <li>1000 BASE-T (10/100/1000 Mbps Ethernet), copper</li> <li>1000 BASE-SX (1000 Mbps Ethernet), MMF Fiber</li> </ul>	<b>Safety</b> <ul style="list-style-type: none"> <li>UL1950, CAN/CSA 22.2, No. 950-M95, (CE Mark) EN60950:1992, A1, A2:1993, A3:1995, A4:1997, A11:1998 with Japanese National Deviations Emission Compliance</li> </ul>
<b>Performance</b> <ul style="list-style-type: none"> <li>Maximum Throughput IP390 400 (400 Mbps), IP390 250 (250 Mbps)</li> <li>Latency less than 200 µs</li> </ul>	<b>Emissions Compliance</b> <ul style="list-style-type: none"> <li>FCC Part 15, Subpart B, Class A, EN50024, EN55022A: 1998, CISPR 22 Class A: 1985, EN61000-3-2, EN61000-3-3</li> </ul>
<b>Management</b> <ul style="list-style-type: none"> <li>SSHv2 (secure Telnet and FTP)</li> <li>Command Line Utilities</li> <li>Image management for system upgrades</li> <li>Element management—a Web-based GUI, Nokia Network Voyager</li> <li>Package management—through Network Voyager and the CLI</li> </ul>	<b>Immunity</b> <ul style="list-style-type: none"> <li>EN55024: 1998</li> </ul>
<b>Environment</b> <ul style="list-style-type: none"> <li>Temperature: 23°F to 113°F / -5°C to 45°C</li> <li>Humidity: 10% – 90% (non-condensing)</li> <li>Altitude: 10,000 ft</li> </ul>	<b>Base System Configuration</b> <ul style="list-style-type: none"> <li>4 Integrated 10/100/1000 Ethernet Interfaces</li> <li>1GB System RAM, expandable to 2GB</li> <li>40GB HDD</li> <li>Integrated PCMCIA Slot</li> </ul>
<b>System Indicators</b> <ul style="list-style-type: none"> <li>10/100/1000 Ethernet port status</li> <li>Power status on system</li> <li>Failure status on system</li> <li>Port status on network interface cards</li> <li>System Operational Indicator</li> </ul>	<b>Optional PMC Cards</b> <ul style="list-style-type: none"> <li>Dual Fail-open Card – Copper</li> <li>Dual Fail-open Card – Fiber</li> <li>2-port 10/100/1000 BASE-T, copper</li> <li>2-Port 1000 baseF, MMF</li> </ul>
<b>Supported Standards</b> <ul style="list-style-type: none"> <li>Designed to meet FIPS 140-2</li> <li>Directive 2002/95/EC Restriction of the Use of Certain Hazardous Substances in Electrical and Electronic Equipment (RoHS)</li> <li>Directive 2002/96/EC Waste Electrical and Electronic Equipment (WEEE)</li> </ul>	<b>Power Requirements</b> <ul style="list-style-type: none"> <li>AC Input Voltage 100-120V/ 200-240VAC</li> <li>Frequency 50/60Hz</li> <li>AC Input Current 3A</li> </ul>
	<b>Dimensions</b> <ul style="list-style-type: none"> <li>Height – 1.75 in (4.4 cm) – 1U</li> <li>Width – 17 in (43.2 cm) without mounting brackets – 1U; or 19 in (48.2 cm) with mounting brackets</li> <li>Depth – 17 in (43.2 cm)</li> <li>Depth – 17.5 in (44.5 cm) at handles, standard bracket position</li> <li>Weight – 18 lbs (8.2 kg) with mounting brackets</li> <li>Front access for upgrades and maintenance</li> </ul>

### Americas

Tel: 1 877 997 9199

Email: ipsecurity.na@nokia.com

www.nokiaforbusiness.com

